

## General Lifting Gear

### 6500 - Plain trolley

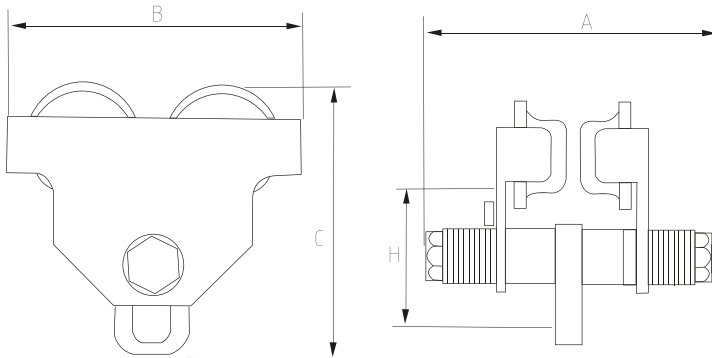

#### Description:

- Suitable for flat and minor irregular surfaces
- Easy installation
- Suspension eye allows easy connection to hooks and other lifting gears
- CE, Traceability code, WLL & GRIPTON mentioned on label

Standard: EN 12195

Material: Carbon steel

Factor of safety: 4 to 1

Construction: Quenched & tempered

Proof load: Individually proof tested to 1.5 time of working load limit

Finish: Powder coated

Plain trolley								
Part No.	WLL (T)	I beam recommended A (mm)	I beam recommended B (mm)	A (mm)	B (mm)	C (mm)	H (mm)	Net weight (Kg)
6500.0005	0.5	68 - 126	64 - 140	208	196	190	108	5.5
6500.0010	1	80 - 146	64 - 140	242	236	211	115	8.7
6500.0020	2	80 - 168	76 - 165	280	273	236	130	10.4
6500.0030	3	88 - 168	76 - 203	300	320	295	164	24
6500.0050	5	100 - 170	88 - 203	316	366	334	177	36